



Strong As An Ox™

Serial No.

Folding Light Bar



Operator and Installation Manual BX88199

TO BE VALID, THE WARRANTY CARD MUST BE COMPLETED IN ITS ENTIRETY BY AN AUTHORIZED DISTRIBUTOR OR DEALER AND SENT TO AUTOMATIC EQUIPMENT MFG. CO., PENDER, NEBRASKA OR REGISTERED ONLINE AT www.blueox.us. FAILURE TO DO SO WILL VOID THE WARRANTY.



Strong As An Ox™

Installation

Step 1

Insert the receiver end of the Light Bar into any two inch receiver. See Figure 1, below.

Step 2

Insert the 5/8" receiver pin into the receiver to hold the Light Bar. See Figure 2, below

Step 3

Attach the clip to the 5/8" pin. See Figure 3, below.



Figure 1-Inserting Light Bar Into Receiver



Figure 2-Inserting Receiver Pin



Figure 3-Inserting Receiver Pin Clip



Installation

Step 4

Remove the 26 foot long 4-wire flat female wire from the box. Begin by plugging it into the Light Bar's male connector. Make certain you leave enough extra wire at the rear of the towed vehicle. Do this by securing it to a suitable anchor point under the rear bumper using a black wire tie. See Figure 4, below.

Step 5

Next, route the loose end of the 26 foot length of wire to the front of your towed vehicle. Make sure you secure it to your towed vehicle using the black wire tie's included in the kit. When securing the wire make sure it is placed away from exhaust pipes, drive lines, suspension components and/or any of the vehicle's moving parts. See Figure 5, below.

Step 6

Wire the loose end of the 26 foot length wire into your 4 or 6 pin connector. See Sketch 1, below.

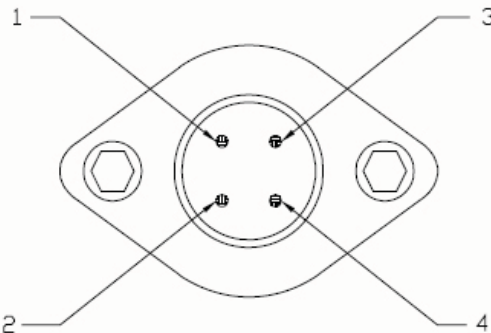

Figure 4-Attaching 4 Wire Plug



Figure 5-Routing/Securing Wire

Socket Pin #	Wire Color	Motorhome	Towed Vehicle
2	White	Ground	Ground
4	Brown	Tail Light	Tail Light
1	Yellow	Left Turn/Stop	Left Turn/Stop
3	Green	Right Turn/Stop	Right Turn/Stop



Sketch 1-4 Wire Plug Wiring



Strong As An Ox™

Adapters

Light Bar Adapters (purchased separately)

- 84-0099 ASSY, LIGHT BAR EXTENSION (Figure 5)
- 84-0100 ASSY, LIGHT BAR, 1 1/4 ADAPTER (Figure 6)
- 84-0101 ASSY, LIGHT BAR, CARRIER ADAPTER (Figure 7)

The 84-0099 would be used in the event that the vehicle's receiver does not extend past the bumper.

The 84-0100 would be used to adapt the light bar to be used on a 1 1/4 receiver.

The 84-0101 would be purchased to use the light bar on the SC2100 Blue Ox sport carrier when they are locked in the up position.



Figure 5-Assembly, Light Bar Extension



Figure 6-Assembly, Light Bar, 1 1/4 Adapter

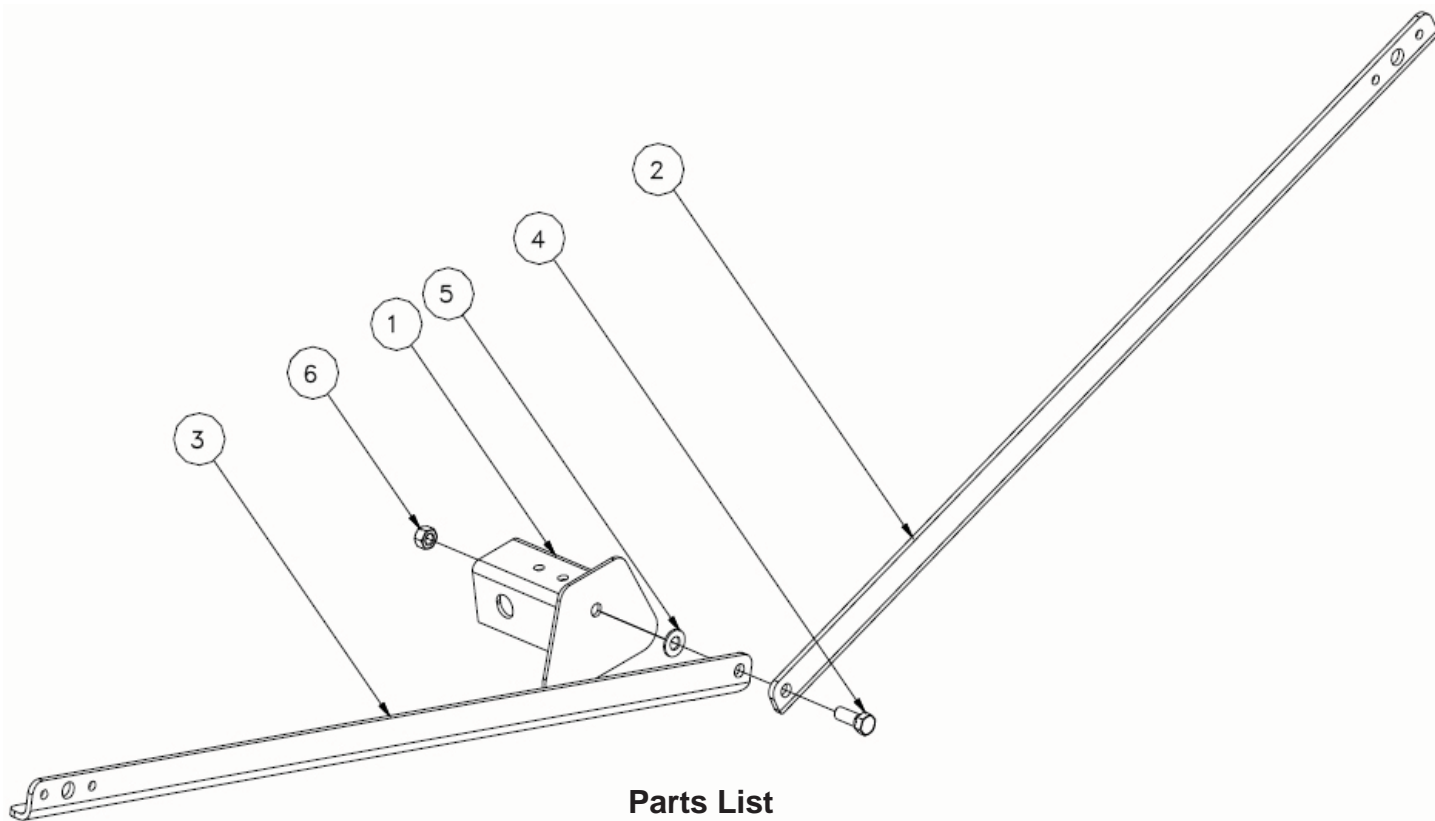

Figure 7-Assy, Light Bar, Carrier Adapter



Strong As An Ox™

Parts List



Parts List

Ref. No.	Qty.	Part No.	Description
1	1	61-6040	WLDMT, REC'R, BX88199
2	1	101-6745	PLATE, LEG RIGHT, BX88199
3	1	101-6746	PLATE, LEG LEFT, BX88199
4	1	201-0443	3/8-16 X 1 HEX BOLT GRD.5, ZPP
5	2	203-0003	3/8 FLAT WASHER, ZP
6	1	202-0090	3/8-16 HEX NYL. INS. LOCK NUT, ZP
7*	1	62-3548	ASSY, WIRING HARNESS, BX88199
8*	1	84-0099	ASSY, LIGHT BAR EXTENSION
9*	1	84-0100	ASSY, LIGHT BAR, 1 1/4 ADAPTER
10*	1	84-0101	ASSY, LIGHT BAR, CARRIER ADAPTER
11*	1	201-0368	3/8-16 X 1 1/4 HEX HEAD BOLT,GRD. 5
12*	4	202-0069	1/4-20 HEX FLANGE WHIZ LOCK NUT, ZP
13*	2	294-0880	LIGHT, TAIL, ROUND

* items not shown.

IMPORTANT: Use only genuine factory replacement parts on your bracket kit. Do not substitute homemade or nontypical parts. If a bolt is lost or in need of replacement, for your safety and the preservation of your bracket kit, be sure to use a replacement bolt of the same grade. Repair parts may be ordered through your nearest **Blue Ox**® dealer or distributor.