



It's from Blue Ox. So you know it's built tough.

BedSaver™

OPERATOR AND
INSTALLATION MANUAL

BXR4900

ROBIN INDUSTRIES 16K

Serial Number



Unless otherwise specified, the bedsaver will NOT work with aftermarket pin boxes. See fit list.

TO BE VALID, THE WARRANTY CARD MUST BE COMPLETED IN ITS ENTIRETY AND SENT TO AUTOMATIC EQUIPMENT MFG. CO., PENDER, NEBRASKA OR REGISTERED ONLINE AT www.blueox.com. FAILURE TO DO SO WILL VOID THE WARRANTY.



Safety Information

SPECIAL DANGER MESSAGE

The act of uncoupling your fifth wheel trailer from your tow vehicle is, singularly, the most dangerous act to be performed when RVing. Dropping the fifth wheel has been reported to cause severe injuries including broken bones, severed limbs and even death by crushing if body parts are placed between the tow vehicle and frame of the fifth wheel trailer. All of these accidents are completely avoidable by following a few simple rules, even without installing the BedSaver™ on your hitch.

- * Chock your trailer wheels.
- * Extend your front jacks until you see no weight is on the hitch.
- * NEVER place any part of your body between the trailer frame and tow vehicle or hitch.
- * NEVER allow any helper or observer to place any body part between the trailer frame and tow vehicle or hitch.

BedSaver™ prevents damage to your tow vehicle when an inadvertent release happens. BedSaver™ may NOT prevent injury to someone violating the simple rules above.

For a safe and happy RVing experience follow the rules listed and NEVER COMPROMISE SAFETY.

Safety Information

- 1) Blue Ox™ strongly recommends installation by a certified technician.
- 2) DO NOT ATTEMPT TO INSTALL THIS PRODUCT WITHOUT FIRST READING THESE INSTRUCTIONS.
- 3) WARNING! FAILURE TO INSTALL THIS PRODUCT PROPERLY CAN RESULT IN DAMAGE TO YOUR FIFTH WHEEL TRAILER, TOW VEHICLE, FIFTH WHEEL HITCH AND/OR CAUSE BODILY INJURY.
- 4) This product is not designed or intended for use with fifth wheel trailers having a pin weight of 4000 pounds or more.
- 5) Your BedSaver™ should be inspected for damage after each incident. **NOTE: An incident is defined as any time a BedSaver™ catches your trailer.**

If the bedsaver is in a incident, it must be replaced. DO NOT use it again! An incident can cause unseen damage and using it again could result in more damage or serious injury. DO NOT use the bedsaver if it is damaged or missing parts.

Special Messages Definitions:

“**NOTE**” provides enhancement information pertinent to the specific step of the procedure being undertaken.

“**CAUTION**” indicates a potential hazard exists that could result in damage to the tow vehicle, fifth wheel trailer or the fifth wheel hitch.

“**WARNING**” indicates a potential hazard exists that could result in personal injury, or death.

Assumptions

Before installing the Blue Ox Bedsaver please verify the fifth wheel hitch you have is installed properly.



WARNING

- USE ONLY GENUINE FACTORY REPLACEMENT PARTS -

Do NOT substitute homemade or non-typical parts. This may cause your carrier to fail and result in injury or death. If repair parts or components are needed, you may order them through your nearest Blue Ox® Dealer or Distributor, or call our 24/7 Customer Care Team at (402) 385-3051.

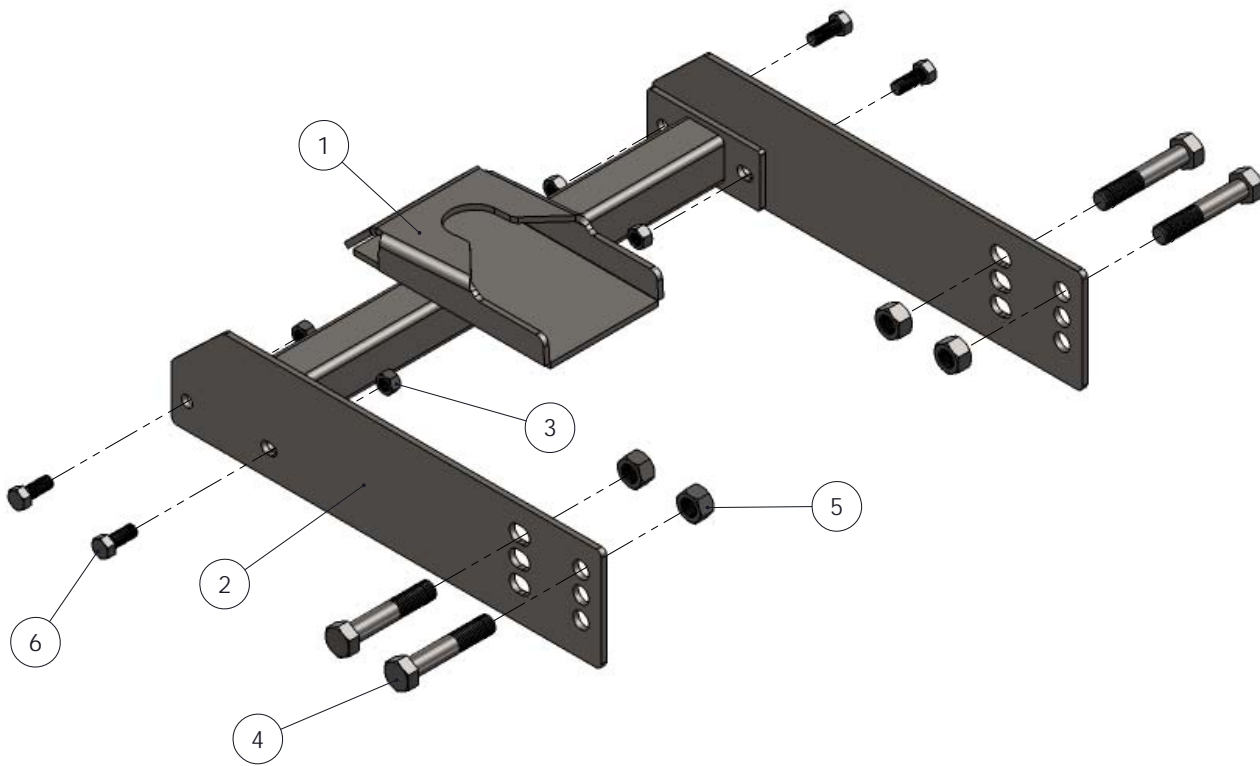

ITEM NO.	PART NUMBER	DESCRIPTION	QTY.
1	61-6109	WLDM'T, BEDSAVER X-TUBE, 23 1/4"	1
2	101-7522	PLATE, BEDSAVER SIDEPLATE, BXR4900	2
3	202-0094	1/2-13 HEX NYL. INS LOCK NUT	4
4	201-0346	3/4-10 X 4 HEX BOLT, GRD. 8, ZP	4
5	202-0107	3/4-10 HEX NYL. INS. LOCK NUT, ZP	4
6	201-0011	1/2-13 X 1 1/4 HEX BOLT GRD. 5, ZP	4



DO NOT INSTALL OR USE THIS EQUIPMENT UNTIL THE FOLLOWING OPERATING AND INSTALLATION INSTRUCTIONS HAVE BEEN READ AND UNDERSTOOD.

INSTALLATION

Requirements for placement of BedSaver™ Side Plates

The BedSaver™ Side Plates are mounted with the bottom mounting holes aligned with the Hitch Side Frame bottom mounting holes. The BedSaver™ Side Plates are mounted with the beveled corners located on the top and toward the front of the tow vehicle.

Note: You will find a label on each Side Plate. The labels should be placed to the outside of the hitch.

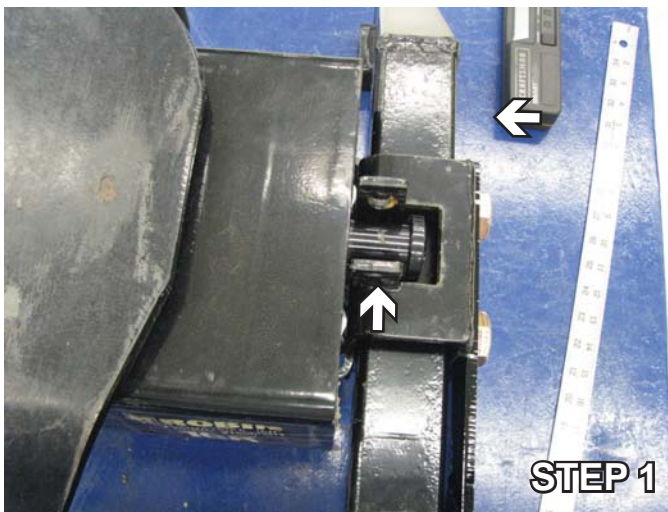

1. To ease installation of the side plate, it is necessary to remove the hitch head. This allows access to the hardware that secures the vertical supports. At each end of the hitch, remove the hairpins that secure the clinch pins (which keep the hitch head on the hitch frame). Carefully lift the hitch head off of the frame and set aside.

2. To mount the BedSaver™ Side Plates, it is necessary to replace the vertical support mounting bolts with slightly longer mounting bolts. Discard the original bolts and nuts. Using a 1 1/16" socket and a 1 1/8" wrench, remove one vertical support mounting bolt. NOTE: Each bolt will be replaced one at a time to ensure the vertical supports remain in their original positions. Replace this bolt with one of the 3/4-10 X 4" bolts supplied in the kit. Place this bolt in the hole just vacated from the inside of the hitch. Loosely attach 3/4-10 lock nuts. Repeat for the remaining three vertical support mounting bolts, two for each support.

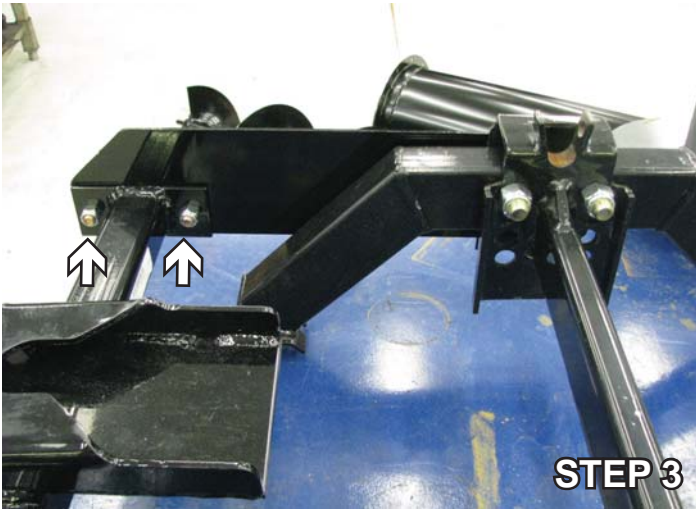

3. Using the four 1/2 x 1 1/4" bolts and 1/2-13 lock nuts supplied with the kit, attach the cross tube Weldment to the left and right Side Plates.

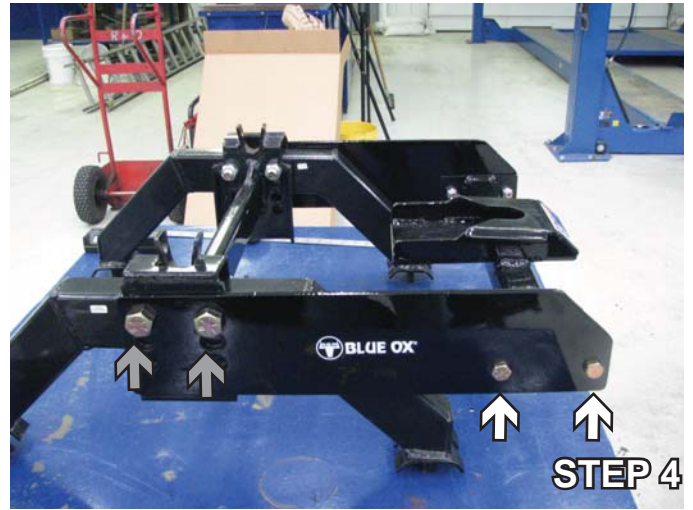

4. Tighten the 1/2-13 x 1 1/4" hex bolts with Loctite (white arrows) attached to 1/2-13 lock nuts. Lift up. Measure to be sure there is 5" from the bed saver x-tube to the weldment bracket. Tighten the 3/4-10 X 4" bolts (gray arrows). Tighten all nuts on the bed saver mounting bolts to a minimum of 65 ft-lbs.



5. Lift and place the hitch head back onto the vertical supports and reinsert the hairpins.

To find the Blue Ox dealer nearest you,
visit www.blueox.com or call (402) 385-3051.

Customer Service Commitment

Blue Ox® is focused on providing exemplary customer service, as observed in our mission statement and guiding principles. In accordance with this objective, Blue Ox® is proud to provide services such as repairs and general maintenance of Blue Ox® products at over 150 RV Rallies. Look for our Destination America or Blue Ox® service crews at the next rally or race that you attend. If you were not present, you will find an informative, personalized note explaining any services that may have been performed to your Blue Ox® products.

Blue Ox® also offers educational seminars at rallies and through our Parks and Resort teams. In addition, Blue Ox® customers visiting our factory may take advantage of free use of the well-equipped Blue Ox® RV park at no charge to you, our valued and appreciated customer.



Strong As An Ox™