

BLUE OX[®]

OverBilt[®] SportLoader[™] Service Support Stand

Installation Instructions

The SportLoader Service Support Stand is a versatile tool allowing you to service, wash or detail your motorcycle at a comfortable height. Rather than having to bend over to work on the bike, you simply place the ramp extensions on the SportLoader, secure the stand under the end and run the bike out of the pickup. The Service Support Stand secures the SportLoader in the horizontal position, making service or detailing easy.

Unpacking your SportLoader Service Support Stand

Remove the SportLoader Service Stand from the shipping carton, referencing the parts list below. Verify you have all of the parts **BEFORE** you start the installation process. If you do **NOT** have all the components, please contact a Blue Ox dealer or distributor. You can also contact a member of Blue Ox's 24/7 Customer Care Team at (402) 385-3051 or toll free at (888) 425-5382 to order replacement parts.

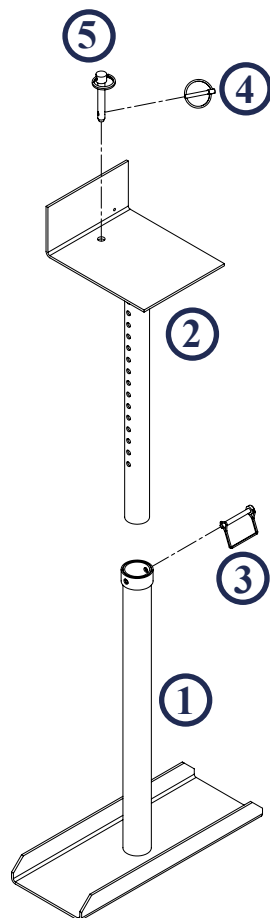

Parts List

Ref. #	Part #	Qty.	Description
1	61-6181	1	Weldment, Support Stand Base
2	61-6182	1	Weldment, Support Stand Adjustor
3	229-0440	1	Spring Lock Pin, 5/16" x 2 1/2" EF
4	84-0001	1	Quick Pin Assembly
5	229-0520	1	Pin, 1/2" x 2 5/8"

WARNING:

USE ONLY GENUINE FACTORY REPLACEMENT PARTS. Do **NOT** substitute homemade or non-typical parts. This may cause your support stand to fail and result in injury or death. If repairs of parts or components of your support stand are needed, you may order them through your nearest Blue Ox[®] dealer or distributor, or call our 24/7 Customer Care Team at (402) 385-3051 or toll free at (888) 425-5382.

Assembly and Use

1. To assemble the SportLoader Service Support Stand, remove the spring lock pin from the Service Support Stand base, slide the Service Support Stand adjuster into the Service Support Stand base.
2. With the ramp extensions already installed on the SportLoader, slide the Service Support Stand under the end ramp extension.
3. To secure the Service Support Stand, insert the ½-inch pin through the SportLoader and Service Support Stand. Finish by placing clip through the bottom of the quick pin.
4. Extend the Service Support Stand to the appropriate height, the base needs to be perpendicular to the SportLoader for stability. Secure the Service Support Stand by placing the spring lock pin in the assembled leg of the stand.

**CAUTION**

Do not use the SportLoader Service Support Stand without all security pins in place. Failing to do so could result in personal injury, product or property damage.



At Blue Ox® we pride ourselves in offering exceptional customer service to our valued customers.

If you have any questions, comments, or concerns please feel free to contact a member of our 24/7 Customer Care Team by calling (402) 385-3051 or toll free at (888)425-5382.

BLUE OX® Customer Service Commitment

Blue Ox® is focused on providing exemplary customer service, as observed in our mission statement and guiding principles. In accordance with this objective, Blue Ox is proud to provide services such as repairs and general maintenance of Blue Ox products at over 150 RV Rallies. Look for our Destination America or Blue Ox Racing service crews at the next rally or NASCAR race that you attend. If you were not present, you will find an informative, personalized note explaining any services that may have been performed to your Blue Ox products.

Blue Ox also offers educational seminars at rallies and through our Parks and Resort teams. In addition, Blue Ox customers visiting our factory may take advantage of the well-equipped Blue Ox RV park at no charge to you, our valued and appreciated customer.



© 2005 Blue Ox
One Mill Road, Industrial Park
Pender, Nebraska 68047
Phone: (402) 385-3051
Toll Free: (888) 425-5382
Fax: (402) 385-3360
www.blueox.us
292-2784