



BLUE OX®

TigerTrak

TT2302 Instructions

W20, W22 and W24 Workhorse
Motor Home Chassis Rear Bar



! ATTENTION

Use these torque specs, **UNLESS** otherwise specified.

Torque Specs	
Bolt Description	Torque Spec.
1/2 x 4.5 U-bolt	75 ft/lbs
1/2 x 1 1/2 USS GR. 8	95 ft/lbs
1/2 x 2 USS GR. 8	95 ft/lbs
1/2 x 2 1/2 USS GR. 8	95 ft/lbs
1/2 x 3 USS GR. 8	95 ft/lbs
1/2-13 x 1 SQ. Set Screw	75 ft/lbs
1/2 x 1 1/4 SAE GR. 8	75 ft/lbs
5/8 x 2 SAE GR. 8	150 ft/lbs
5/8 x 2 3/4 SAE GR. 8	150 ft/lbs
3/4 x 3 SAE GR. 5	150 ft/lbs
3/4 x 3 1/2 SAE GR. 5	150 ft/lbs
3/4 X 5 SAE GR. 5	150 ft/lbs
12-1.75 x 55 MM HEX 10.9	65 ft/lbs
12-1.75 x 120 MM HEX 10.9	65 ft/lbs
12-1.75 MM HEX NUT 10.9	65 ft/lbs
14-2.0 x 40 MM HEX 10.9	125 ft/lbs
14-2.0 x 80 MM HEX 10.9	125 ft/lbs

Tools Required

18MM Combo Wrench	1-1/8" Socket
1-1/8" Combo Wrench	3/4" Socket
3/4" Combo Wrench	15/16" Socket
1/2" Drive Ratchet	7/8" Socket
1/2" x 6" Extension	22MM Socket
1/2" Torque Wrench	18MM Socket
	16MM Socket

! ATTENTION

A qualified mechanic using normal automotive tools and following all safety measures known should perform installation of this product.

TigerTrak

TT2302 Instructions

W20, W22 and W24 Workhorse
Motor Home Chassis Rear Bar

Parts List

Ref. No.	Qty.	Part #	Description
1	1	101-7142	BRACKET, SPICER135/150 REAR END, TT
2	1	101-7143	BRACKET, SPICER110/115 REAR END, TT
3	1	101-7126	FRAME BRACKET, TT
4	1	61-6437	WLDM'T, ROD TT2302
5	2	201-0632	3/4-16 X 3 HEX BOLT GR 5 ZP
6	4	203-0007	3/4 FLAT WASHER, ZP
7	4	250-0217	BUSHING, URETHANE, TT
8	1	61-6418	WLDM'T, ROD END, RIGHT THREAD, TT
9	2	107-2969	TUBE, BUSHING INSERT, TT
10	2	202-0168	3/4-16 STOVER LOCK NUT ZP
11	1	202-0149	3/4-16 NUT, HEX JAM, ZP
12	2	201-0621	1/2-13 X 2 HEX BOLT, GRD.8, ZP
13	1	201-0562	1/2-13 X 3 HEX BOLT, GRD. 8, ZP
14	3	203-0012	1/2 LOCK WASHER, ZP
15	2	201-0813	14MM-2MM X 50MM HX BT,GD 10.9, BLK
16	1	201-0812	14MM-2MM X 80MM HX BT, GD 10.9, BLK
17	3	203-0131	WASHER, 14MM LOCK, ZP
18	3	201-0153	1/2-13 X 2 1/2 HEX BOLT GRD.5, ZP
19	3	202-0185	1/2-13 HEX NUT, NYL INS. LK.GD 8,ZP
20	1	62-3628	ROD, ASSY, TT2302
	3	203-0168	1/2 INCH FLAT WASHER, ZP, SAE (NOT SHOWN)
	2	290-0275	8" LONG CABLE TIE, BLK (NOT SHOWN)
	1	190-0155	LOOM, FLEX GUARD, .413 I.D. (BULK) (NOT SHOWN)
	1	XA1-0049	LOCTITE RED, 262, TUBE, .02 FL. OZ. (NOT SHOWN)

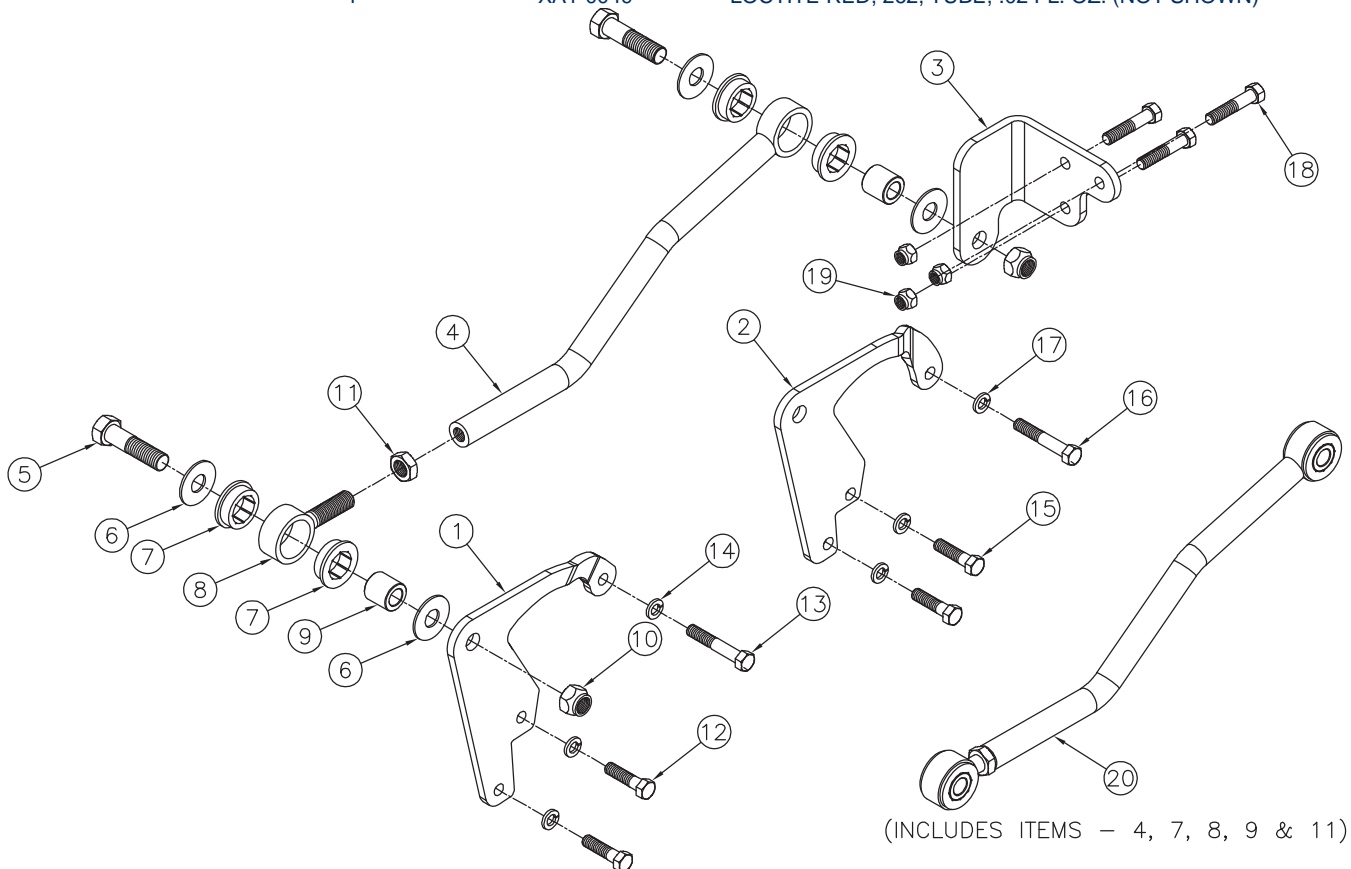

TigerTrak

TT2302 Instructions

W20, W22 and W24 Workhorse
Motor Home Chassis Rear Bar

Installation Instructions:

1. Move the coach to a level, flat surface. By driving the coach back and forth 10 feet once or twice, ensure the vehicle's front wheels are straight ahead before starting installation. Set the brake and chock wheels.

! IMPORTANT

There are two (2) Differential Brackets (#1 and #2) in the kit. One fits the Spicer metric rear (110-115) and one fits the larger rear (135-150). Match the bracket to the bolt pattern and discard the one that does not fit.



! IMPORTANT

Some OEM bolts may be metric. Check the size closely before installation. Metric bolts are larger and provided.

2. Installation of the Differential Bracket (#1 or #2), refer to Photo (#1). Hold the Differential Bracket (#1 or #2) up to the differential to locate the 3 OEM bolts. Remove the bolts and discard. Install the Differential Bracket (#1 or #2) to the differential with the supplied bolts (size 1/2" x 2") or metric and lock washer. Be sure to use Loctite on the bolts before installing. If flat washers are used on OEM bolts reuse the flat washers between the bracket and the differential casting. Torque to spec. (See chart)



3. Installation of the Frame Bracket (#3), refer to Photo (#2). The Frame Bracket (#3) is bolted to the right-hand side (passenger side) on the inside of the frame rail at the Jounce Bumper. Begin by removing Jounce Bumper and Bracket from the frame (on the passenger side of the frame). (See photo #2) Loosen or remove Jounce Bumper from its mounting bracket. Replace three of the bolts with the longer ones provided in the kit. If you removed the Jounce Bumper from its bracket reattach it to that bracket and reinstall on the outside of the frame. Install the Frame Bracket (#3) on the inside of the frame where the bolts are sticking through. Apply Loctite and put on the Nylock nuts provided (See Photo #2). Torque to specs (See chart).

TigerTrak

TT2302 Instructions

W20, W22 and W24 Workhorse Motor Home Chassis Rear Bar

4. Installation of Rod Assembly (#20) – Install the Rod Assembly (#20) using the 3/4” bolts, flat washers and lock nuts. Be sure that there is a flat washer on each side of the urethane bushings. When adjusting the length of the Rod Assembly (#20), it is necessary that the coach’s full weight be on the suspension. NOTE: Rod Assembly (#20) should be installed at the rear of the bracket.

5. Be sure to check all fasteners for proper torque (See torque chart), including the jam nut, which must be 100-150 ft. lbs. on the Rod Assembly (#20). Inspect for any wires or hoses that may rub, if so use supplied split loom to cover the wires or hoses and the supplied snap ties to secure. This completes the installation.



© 2008, 10 Blue Ox
One Mill Road, Industrial Park
Pender, Nebraska 68047
Phone: (402) 385-3051 • Fax: (402) 385-3360
www.blueox.com